

## 670127 1/2" DIAPHRAGM PUMP (WITH POLYPROPYLENE FLUID SECTION)



**READ THIS MANUAL CAREFULLY BEFORE INSTALLING,  
OPERATING OR SERVICING THIS EQUIPMENT.**

It is the responsibility of the employer to place this information in the hands of the operator. Keep for future reference.

Model 670127 is similar to a model 666053-0D2 diaphragm pump, therefore a 66605X-X Operator's Manual (PN 97999-099) should be used for General Information, Installation, Operation and Maintenance. This pump uses duckbill style checks.

bottom (this is the reverse of a standard pump). In addition, this pump uses a different muffler and cover.

**USE SERVICE KITS:**  
637141 for Air Section  
637140-D2 for Fluid Section

**INSTALLATION NOTE:** This pump has the inlet on top and outlet on the

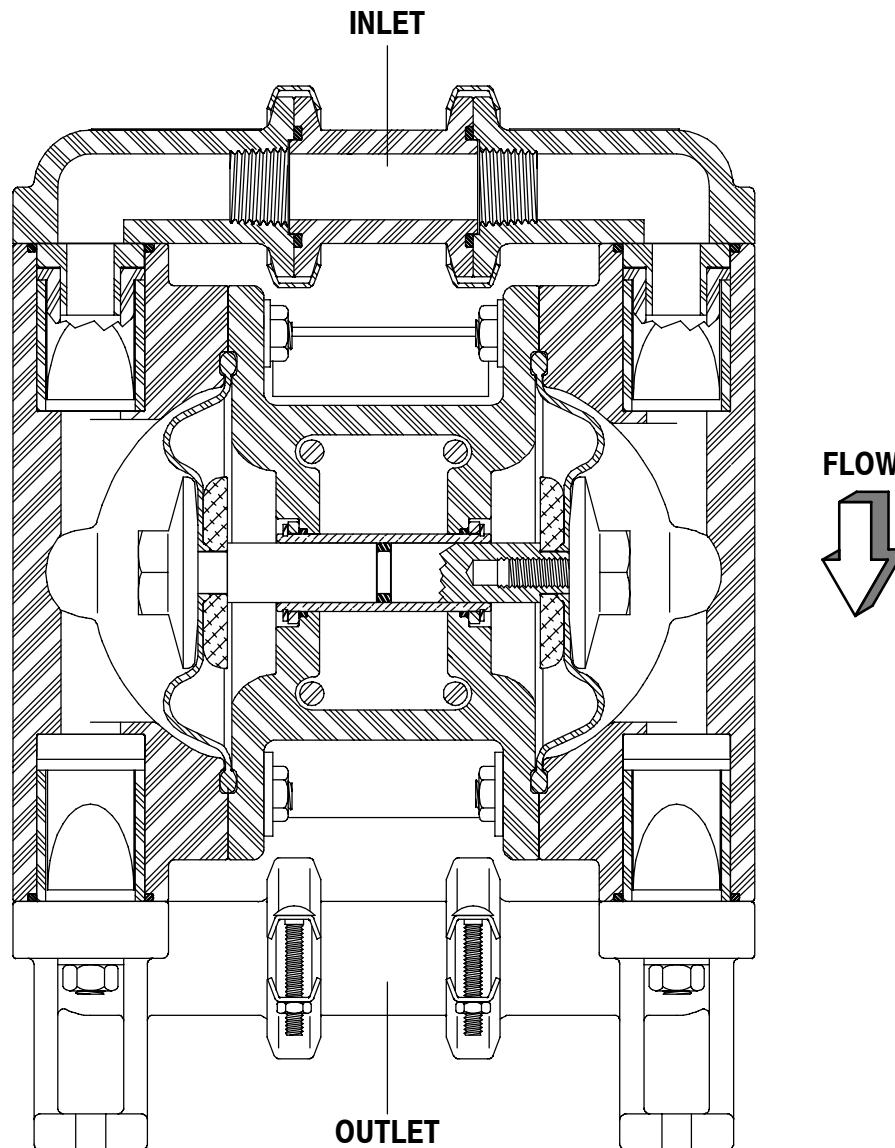

PN 97999-1717

**INGERSOLL RAND COMPANY LTD**  
209 NORTH MAIN STREET - BRYAN, OHIO 43506  
(800) 495-0276 • FAX(800) 892-6276  
www.ingersollrandproducts.com

© 2013 CCN 47512083001

**ARO**   
Industrial Technologies